



**PATENTED
PRODUCT**
système breveté

BEABA

Instructions

Notice d'utilisation
Folleto de Instruccion
Instruções de utilização



BABYCOOK®

the original babyfood maker™

BEABA

www.beaba.com

www.beabausa.com

Registered in US Patent and Trademark Office

IMPORTANT SAFEGUARDS

When using electrical appliances, basic safety precautions should always be followed including the following :

1. Read all instructions.
2. Do not touch hot surfaces. Use handles or knobs.
3. To protect against electric shock do not immerse cord, plugs or appliance in water or other liquid.
4. Close supervision is necessary when any appliance is used by or near children.
5. Unplug from outlet when not in use and before cleaning. Allow to cool before putting on or taking off parts.
6. Do not operate any appliance with a damaged cord or plug or after the appliance malfunctions or has been damaged in any manner. Return appliance to the nearest authorized service facility for examination, repair or adjustment.
7. The use of accessory attachments not recommended by the appliance manufacturer may cause injuries.
8. Do not use outdoors.
9. Do not let cord hang over edge of table or counter, or touch hot surfaces.
10. Do not place on or near hot gas or electric burner, or in a heated oven.
11. Extreme caution must be used when moving an appliance containing hot oil or other hot liquids.
12. Do not use appliance for other than intended use.
13. Before serving be sure food is at safe temperature.
14. Before serving, unplug cord from wall outlet and dish. Do not leave cord within child's reach.

Save these instructions.

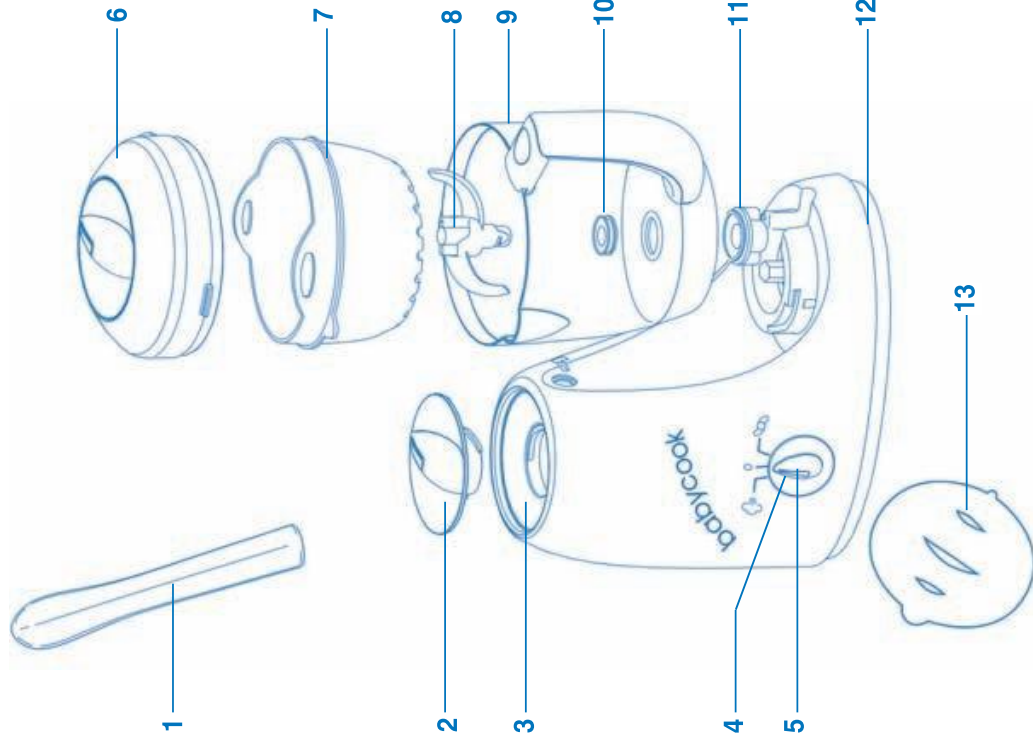

1. Spatula

2. Heating compartment lid ↻

3. Steam heating compartment

4. Food processor controls:

↻ cooking, reheating, defrosting

↻ blending

5. Cooking light

6. Bowl lid: security locking system ↻

7. Cooking, reheating, defrosting basket

8. Removable food processor blades:
easy to clean

9. Cooking bowl ↻

10. Gasket



11. Bolt for detaching blades

12. Base

13. Mixing lid

U We thank and congratulate you on your choice - you have purchased an appliance that has unique performance features. **BABYCOOK** has been specifically designed to prepare healthy meals for your baby, simply and rapidly. **BABYCOOK** cooks, reheats and defrosts food by steaming, which locks in the vitamins."

HOW TO USE

- The appliance consists of a technical pedestal unit that incorporates a lidded heating reservoir, a removable food preparation bowl that takes the cooking basket insert, the food processor blades, the mixing lid and bowl lid.
- To lock the heating compartment lid turn it clockwise .
- The cooking bowl lid locks by turning it counter clockwise .
- After heating, the basket should be removed from the cooking bowl using the spatula slotted through the basket handles.
- Care should always be taken when handling the food processor blades (very sharp blades) and also when taking hold of the bowl and its accessories after cooking, the residual condensed water is very hot at the end of cooking time.



- **When the appliance is brand new, it is harder to lock the bowl, make sure you latch the bowl by turning it counter clockwise until you hear it "CLICK", the appliance is then fully engaged.**



- **If the bowl is not fully engaged, the safety device on the appliance lid will prevent it working.**

- This appliance has a polarized plug. To reduce the risk of electric shock, this plug is intended to fit into a polarized outlet only one way. If the plug does not fit fully into the outlet, reverse the plug. If it is still does not fit, contact a qualified electrician. Do not attempt to modify the plug in any way.

- A short power supply cord is provided to reduce the risk resulting from becoming entangled in or tripping over a longer cord.
- Longer extension cords may be used if care is exercised in their use.
- If an extension cord is used,

- 1) The marked electrical rating of the extension cord should be at least as great as the electrical rating of the appliance and
- 2) The longer cord should be arranged so that it will not drape over the countertop or table top where it can be pulled on by children or tripped over unintentionally.



WARNING

Never immerse the electrical unit in water.

Plug the BABYCOOK into a 110 V grounded socket

COOKING

The lower part of the bowl is marked with a 1- 3 measuring scale. These mark lines are for measuring how much water to pour into the heating reservoir and set the cooking time. (Refer to the cooking guide, page No.6)

- Pour the right amount of water into the cooking bowl (using the mark lines).
- Pour the water into the heating compartment and lock the heating compartment lid.
- Place the basket with its content of diced food in the bowl making sure that the basket tab lines up with the large pouring lip of the bowl, lock the bowl lid tightly onto the bowl, then lock the whole unit onto the pedestal.
- Plug the appliance and turn the button to the left towards the steam symbol .
- When the cooking indicator light goes out, unlock the bowl lid by turning its knob. Lift out the basket using the spatula and pour the contents into the bowl. Depending on the recipe you will either pour away or keep part of the cooking liquid.
- Only room temperature water should be put into the heating reservoir.

BLENDING

- Place the mixing lid on the cooking bowl horizontally and ensure that it is lying on the pins inside the cooking bowl so that it does not slip down when mixing.
- Lock the lid tightly onto the bowl, then lock the whole unit onto the pedestal.
- Plug the appliance and turn the button to the right towards the blender symbol , until you get the right consistency (pulse action normally lasts 10 seconds).

REHEATING

- Food that needs to be reheated should be placed inside a heat resistant jar and placed uncovered in the cooking basket.
- Pour in 1 measure of water then proceed as for the cooking cycle.
- When the indicator light goes out, lift out the jar using a cloth, (warning - any water left over at the end of the cooking time is very hot) then mix the contents so that the temperature is even.

DEFROSTING

- Follow the same method as for reheating, but pour in 2 measures of water instead of 1, and proceed with cooking and mixing as explained earlier.

NOTE : Naturally it is best to use fresh fruit and vegetables because they offer the highest vitamin content, but of course you can use your BABYCOOK to cook frozen fruit and vegetables that have been defrosted either directly in the BABYCOOK or in the refrigerator (never defrost food at room temperature).

OFF

- Turn the button back to the 0 symbol every time after use.

COOKING GUIDE

Food	Measures of water		
	1	2	3
Vegetables			
Potatoes			•
Carrots*			•
Turnips*			•
Runner beans		•	
Zucchini		•	
Leeks			•
Peas			•
Pumpkin			•
Cauliflower			•
Meat			
Red Poultry			•
Fish			
Fruit			
Apples		•	
Pears		•	
Strawberries		•	
Mandarin oranges		•	
Pineapple			•
Cooking time	approx. 7 minutes	approx. 10 minutes	approx. 15 minutes

* All food should be diced.

CLEANING

- Always unplug the appliance before you start cleaning it.
- Immediately rinse the accessories that have come into contact with the food under running water to prevent germs from forming.
- Descale the heating reservoir from time to time with white vinegar (distilled). Never use a chemical descaler or a descaler for coffee machines in the reservoir.** Pour 3 measures of distilled vinegar, into the heating reservoir. Run one cooking cycle then rinse carefully. Then run two heating cycles with plain water only (3 measures) in the reservoir to rinse it properly.
- After you have cleaned the blade, make sure that the gasket is properly back in place.

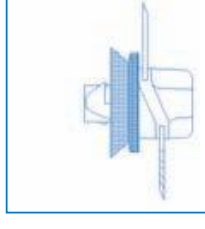
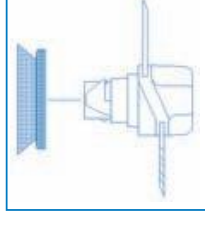

Placing the gasket on the blender cutter

- Babycook accessories are not suited to sterilisation.

RECOMMENDATIONS

- Never put the bowl on the pedestal without the food processor blades in place.
- Do not move the appliance or put a cover over it while in use.
- Never immerse the electrical pedestal unit in water.
- Keep the BABYCOOK out of children's reach and always lock the bowl lid fully so that the blade is inaccessible.
- Use the BABYCOOK on a flat, stable surface and stable.
- Plug the Babycook into a 110V grounded socket.
- Do not run the BABYCOOK in cooking mode when the reservoir is dry.
- Do not fill the bowl above the mark lines.
- Regularly check that the steam outlet hole on the bowl is not blocked. Do not add water to the cooking bowl before mixing. There is a risk of very hot liquid being splashed when mixing.
- Never lean over the steam outlet hole during the cooking cycle (risk of scalding).
- Handle hot parts with great care.
- Regularly de-scale the heating reservoir.**
- If you need to make a claim, please quote the number printed on the label located on the underside of the Babycook heating pedestal.
- Any handling of the device must be carried out under the responsibility of an authorized person.
- Turn the on/off switch to 0 after each steaming cycle.

- The mixing blade must always be placed in the cooking bowl in cooking mode and mixing mode.
- Never unlock the cooking bowl from its base before the cooking light has been switched off and before the device has cooled completely.
- Never open the cooking bowl before the device has cooled.
- Use only water or white vinegar (for descaling) in the heating reservoir. Never put food, salt or any other non-recommended elements in the heating reservoir.
- Never leave water in the reservoir. Empty any leftover water after each use.

TECHNICAL DATA

Voltage: 110 V ~ / 50-60 Hz

Power: 350 W (motor 120 W)

MANUFACTURER'S LIMITED WARRANTY

Beaba warrants its products to be free from substantial defects in workmanship and material under normal household use in accordance with the instructions for one (1) year following date of purchase. Beaba will, at its discretion, replace or repair any item requiring service. This warranty shall not apply to damages arising from neglect, accidental damage, or commercial use of the product. This is a limited warranty. Liability for consequential damages is expressly excluded. Proof of purchase is required. To make a claim under this warranty, please contact Scandinavian Child at 1-866-782-6222 to speak with a customer service representative. Please have the model and product number ready. You also can write to us at: Beaba Product Support, c/o Scandinavian Child LLC, P.O. Box 31243, Raleigh, NC 27622 or email: SCService@SCChild.com, or visit our website : www.beabausa.com

Some states do not allow the exclusion or limitation of incidental or consequential damages, so the above limitation and exclusion may not apply to you. This warranty gives you specific legal rights, and you may also have other rights which vary from state to state.